

Microstrip Circulator

Part Number: KTMC-902A20

Key Features

- Frequency Range: 7GHz-13GHz
- Good Consistency
- Small Size, High Precision
- High Isolation, Low Insertion Loss
- Wide Operating Temperature Range: -55°C~+85°C
- Widely Used in Various Millimeter Wave Radar & TR Components

Electrical Specifications at Room (25°C±5°C) Temperature

| Part Number | Freq. Range (GHz) | Bandwidth Max. (MHz) | Insertion Loss Max. (dB) | Isolation Min. (dB) | VSWR Max. | Forward Power (W) | Connector Type |
|-------------|-------------------|----------------------|--------------------------|---------------------|-----------|-------------------|----------------|
| KTMC-902A20 | 7 - 13 | full | 0.8 | 15 | 1.45 | 30 | GWB |

Mechanical Dimensions (mm)

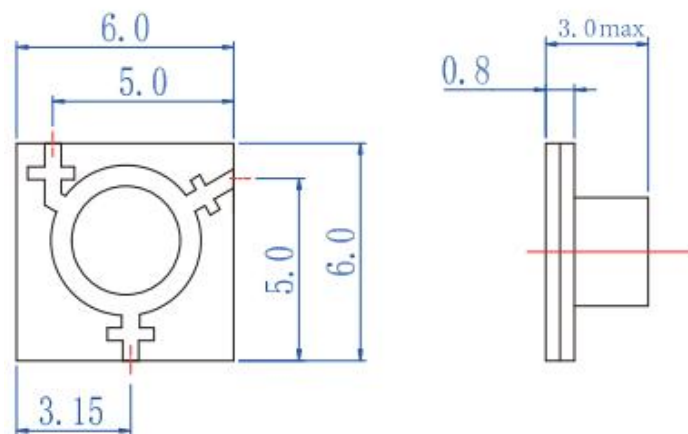

HOW TO ORDER

